



# THIS IS A CONSULTATIVE DOCUMENT

## Proposal Paper

**It is proposed, subject to the outcome of this consultation to:**

- **establish Primary stage Additional Support Needs (ASN) provision at Carrongrange High School to create an all-through 5-18 ASN campus**

*(Schools Consultation (Scotland) Act 2010, Schedule 1, Para 2(b) – “a proposal to establish a new stage of education in a school”)*

**and as a result;**

- **permanently discontinue current provision at Kinnaird Primary School Thistle Wing/Thistle Wing Annexe and Maddiston Primary School Timezone.**

*(Schools Consultation (Scotland) Act 2010, Schedule 1, Para 1(1)(a) – “a proposal to permanently discontinue a school”)*

**The proposed changes would take effect from January 2029, or as soon as possible thereafter.**





## 1. **Background**

In October 2023 Falkirk Council received confirmation from the Scottish Government that a bid to the Learning Estate Investment Programme (LEIP) for funding to support the construction of a new Primary Additional Support Needs (ASN) campus in Grangemouth had been successful.

This proposed new campus development will replace the ASN wings currently located at Kinnaird Primary School Thistle Wing and Thistle Wing Annexe, and Maddiston Primary School Timezone with a single, purpose-built facility, incorporated with Carronrange High School, to provide an all-through 5-18 campus for pupils with severe, complex and profound additional support needs. The new campus will also provide additional pupil capacity where the existing wings have been at full capacity for many years.

Alongside the proposed additional Primary stage ASN provision, there is a planned extension of secondary capacity at Carronrange High School (to replace temporary modular classrooms) as well as a reconfiguration of the schools Green Hub area (for pupils with the most profound learning needs, least mobility, and those requiring the most complex care procedures) to improve facilities and add capacity.

The proposed new and expanded Carronrange 5-18 ASN campus will deliver an outstanding facility for the education and support of pupils with the most complex, profound and severe additional support needs.

A formal consultation in accordance with the Schools (Consultation) (Scotland) Act 2010 is required for any proposal to:

- (a) establish a new stage of education in a school; or
- (b) discontinue a school or stage of education in a school.

These both apply to this proposal as it will build a new ASN primary school, to form part of a larger 5-18 ASN campus at Carronrange to replace the ASN wings associated with Kinnaird and Maddiston Primary Schools. This consultation is fully in accordance with the requirements of this legislation.

The purpose of this consultation is to gather views on the proposal from those that will be most impacted, particularly parents, pupils and staff at the Primary ASN wings and Carronrange High School.





## 2. Proposed Plan for Development of the Carrongrange Campus

### **The new Primary ASN facility will provide:**

- 22 purpose-built ASN core classrooms, each with a dedicated storage area and access to a quiet room. These will comprise 18 dedicated Primary classrooms and 4 “transition” classrooms to be shared between primary and secondary, as required.
- Personal care rooms located throughout to ensure easy access from all classrooms.
- Sensory and soft-play rooms on each floor.
- Large communal space on ground floor for activities, PE and dining.
- Accessible WCs throughout.
- Storage areas for mobility equipment.
- Ancillary areas required for the large number of staff, health partners, meetings and therapeutic interventions that are required for an ASN setting.
- Drop-off and pick-up area at school entrance.
- Safe and secure external play provision and landscaping with outdoor access for many of the classrooms.
- Hoisting and tracking where required, including in personal care rooms and classrooms.

The school will be built and fitted out to the highest standards with regards acoustics, lighting, ventilation, fire safety, security, data networking, and space standards will be generous throughout. The Government funding requires outstanding energy performance for the building, and this will be reflected in consistent and comfortable internal temperatures throughout the year.

The adjacency and interface with Carrongrange High School to form the new all-through Primary/Secondary ASN campus will allow shared access for primary pupils to existing facilities, particularly the swimming pool, hydrotherapy pool and assembly/performance hall.

Four of the classrooms will be specified as transition classrooms for either secondary or primary pupils. This will give flexible capacity for both to accommodate the variable pupil numbers year to year and provide more options for pupils transitioning from primary to secondary.





### **The extension and alterations to Carrongrange High School will also provide:**

- 4 additional core classrooms to replace the 4 temporary modular classrooms currently installed behind the school to provide additional permanent capacity.
- Enhancements to the Green Hub, including the addition of a fourth classroom and associated storage and support spaces, that will provide additional capacity for a further 6 secondary pupils with significant physical disabilities and complex therapy and sensory needs, as well as providing much needed additional storage for all pupils in the Green Hub. This responds directly to rising levels of need and ensures that the learning environment remains fully accessible and appropriately adapted.

In total, the new build provision will provide additional capacity for 8 primary and secondary ASN classes, for up to 48 pupils.

### **Campus Layout**

Appendix 2 of this Proposal Document show the current campus layout overlaid with the proposed layout once completed.

The Primary ASN building will be located to the rear of Carrongrange High School and the Moray Primary School playing fields. This grassed area is under-used by Moray Primary School and will be replaced by an all-weather 3G pitch that can be better used by Moray Primary School and the local community throughout the year.

Only a small increase in car parking allocation is possible on campus, so an additional car park for staff with over 80 spaces will be located across the road in Abbotsinch Industrial Estate, with direct pedestrian access to the campus.

### **Proposed Construction Programme**

The design, layout and delivery phases will be agreed and confirmed following this consultation exercise. Any concerns and suggestions raised during this consultation will be duly considered and will inform the final technical design stage.

The Construction Programme is currently expected to start in 2027 and to complete in 2028.

The Primary ASN building (including Carrongrange High School extension) and Green Hub reconfiguration are all expected to be completed during this construction period and will be phased accordingly to ensure continuous availability of provision at Carrongrange High School and minimise any disruption. At the end of the construction period, together with the existing Carrongrange High School, they will form a single 5-18 ASN campus.





The Contractors Compound and parking will be located off-site on the proposed Abbotsinch car park area to minimise disruption, and care will be taken to programme the noisiest works (e.g. demolition, piling) during holidays and outside school hours where this is possible.

### 3. **Educational Benefits Statement**

#### **Assessment of likely educational benefits on pupils**

If this proposal is implemented, the Council believes that there will be considerable educational benefits. These centre around:

- Learning and teaching.
- Meeting learners needs.
- Broadening the range of opportunities.
- The environment for learning including curriculum.

#### **Learning & Teaching**

Children and young people attending the Carrongrange campus will have a range of profound, severe and complex needs which will require the learning and teaching to be highly differentiated and often bespoke to individuals.

Learning for the children and young people will be planned for and delivered across a range of contexts, including within the learning spaces, sensory rooms, shared areas, outdoors and within the community. The modern, purpose-built campus will provide enhanced, high quality learning opportunities, with all facilities and learning areas designed explicitly around the needs of the children and young people, central to the planning and delivery of a relevant and meaningful curriculum.

The outdoor areas will be purposefully designed to enable staff to plan and deliver meaningful learning experienced on a daily basis, with a particular focus on wellbeing, outdoor learning and a sensory based curriculum.

The integration of high quality, innovative digital and assistive technologies throughout the campus will provide highly engaging and accessible learning experiences, providing opportunities for all children and young people to communicate in a variety of relevant ways, participate and progress through a strengthened total communication approach.

The creation of a single 5-18 campus will bring together staff from multiple ASN provisions, enabling a more coherent and collaborative professional organisation. This will strengthen professional learning, facilitate systematic sharing of effective practice across the primary and secondary sectors and promote greater consistency in effective pedagogy. The integrated staffing model will also enhance the capacity for innovation in meeting the complex needs of learners.





The fully accessible purpose-built facilities will significantly enhance the Council's ability to meet the wider healthcare, emotional and physical needs of children and young people. By removing current environmental barriers, the new campus will ensure that these needs can be addressed seamlessly throughout the school day, enabling pupils to focus more fully on learning and engagement.

### **Meeting learners needs**

For children and young people who attend Carrongrange School, it is important to consider their needs in a holistic way. This includes their educational, physical and healthcare needs and this requires a highly skilled, trained and experienced staff who know them well and can respond to the wide variety of needs across the school community.

By creating a 5-18 campus that allows children and young people to remain in the same provision for their whole school career, this minimises transitions, supports progression and ensures continuity in their learning and support. Strong relationships will ensure children and young people feel safe and secure and will ensure that the wider needs of the families are central to the life and work of the school.

Due to the level of needs of the children and young people, strong partnership working is essential, including strong participation of allied health professionals, medical staff, social work colleagues and family support workers. Through the development of the new campus, facilities can support this strong multi agency approach, ensuring the purpose-built facilities can focus strongly on the wide needs of the whole family and services can be accessed within the familiar environment of the school. This will minimise any distress for children and young people whilst ensuring their privacy, wellbeing and dignity remains a priority.

The high quality, purpose-built facilities across the campus, including the existing swimming pool and hydrotherapy pool, will ensure that children and young people's physical needs can be met through well planned learning opportunities. By bringing together the current ASN wings associated with Kinnaird Primary School and Maddiston Primary School, all children and young people with complex needs will, for the first time, have equitable access to specialist resources and facilities that were previously available only in certain settings, across both internal and external learning spaces.

Close proximity to both primary and early years settings, will continue to ensure, where appropriate, any relevant and meaningful opportunities for inclusion and planned interactions with age and stage appropriate peers can continue to be facilitated.





## **Broadening the range of opportunities**

The new Carronrange campus will provide a modern, purpose built and fully accessible environment designed to meet the complex needs of its learners. It will replace the current accommodation for primary children within this cohort, which no longer reflects the delivery of best practice and the level or nature of need now present, and will enable the development and delivery of a fully inclusive curriculum that is responsive to all children and young people.

The extended provision will allow for a greater range of opportunities to be provided, ensuring access to the most up to date technology, sensory equipment, flexible classroom spaces and engaging outdoor spaces.

By creating an all through campus across primary and secondary, opportunities to build on prior learning ensuring the best outcomes for all learners can be realised. Whilst children and young people will generally be within age and stage appropriate classes, an all through provision will allow greater flexibility in planning around individual needs, creating groupings and opportunities for coming together across the sectors for children with similar needs. This approach ensures that consideration is also given to needs led support and groupings as well as age and stage.

The increased spaces that will be available, alongside the flexibility being created in the use of these, will broaden the experiences and opportunities that can be planned for and delivered bespoke to the needs of all.

Carronrange currently maximise opportunities for learning in the wider local community, where children and young people can engage in essential life skills in real life contexts across amenities, services and facilities. The development of relationships with members of the community and the local workforce has enhanced these opportunities and allows the children and young people, where relevant, to interact appropriately with others.

These opportunities will be available to all pupils and will enhance current opportunities being accessed by children and young people across ASN provisions.

All families will have the opportunity to feel part of an inclusive and nurturing school community where relationships are central to the work of the school. By having the opportunity to be part of an all through single specialist provision, with limited transitions, opportunities for engagement for parents and families will be planned and progressive and responsive to their needs, both to support the engagement and learning of the children and young people as well as to support the wider care, health and family needs that arise across the educational journey from enrolment in Primary 1 through to leaving school.





The purpose built outdoor and indoor social spaces across the new campus will create significantly enhanced opportunities for children and young people to engage in meaningful social interaction with peers and adults. Dedicated areas, including play spaces, social zones and a purpose-built dining facility, will support learning in appropriate contexts and promotes the development of essential life and social skills. The scale of the new campus will also allow a wider range of extra-curricular activities to be developed for pupils with shared interest or talents, delivered by the larger staff team or by external partners who already support Carronrange High School. The design of the new facilities will remove many of the barriers that previously limited participation, ensuring greater access and inclusion for all.

### **Environment for learning including curriculum**

Carronrange campus will be a purpose built, inclusive and accessible learning environment created with the best and most up to date features to benefit children with profound, complex and enduring needs. It will be equipped with specialist resources and facilities to ensure spaces, both indoors and outdoors, meet the wide range of needs of all children and young people. Engagement in learning and the curriculum is highly influenced by the learning environment children are in. For children with complex additional support needs, a range of needs have to be considered to maximise the learning opportunities including: addressing healthcare, physical, mobility and sensory needs; promoting participation and engagement in learning and holistic skills development; reducing over stimulation and ensuring access to appropriate learning resources; and ensuring a communication-rich environment to enable children to use a variety of methods, including the use of IT/digital technology to communicate their needs. Significant adaptations are required to be embedded in the developed and delivered curriculum to ensure progression through pre-early and individual milestones. Every element of the environment and learning campus contribute to the holistic learning and development of life-skills and independence. Every daily activity outwith the classroom is viewed as an opportunity for learning and skills development and contributes to the rich and varied curriculum our children rely on and thrive in to ensure best outcomes for their future lives and wishes.

Planned and daily opportunities for safe and appropriate outdoor learning and play is of huge importance to children with significant developmental needs to ensure they have opportunities to progress through developmental milestones at their own pace and readiness.

Spaces and resources already available at Carronrange High School such as therapy areas, a proprioception room, hydrotherapy and pool, and landscaped garden and play spaces, contribute positively to the wellbeing and sensory needs of the children at Carronrange and are key to supporting their participation and engagement in learning.





At Carrongrange, the design of spaces has given full consideration to accessibility and the range of needs of the children and young people and will maximise learning opportunities for all. The delivery of the curriculum must ensure a strong focus on literacy and communication, numeracy, health and wellbeing and life skills. The environments across the campus and the wider community will provide the opportunity to deliver a high-quality curriculum, personalised and relevant to the needs of all.

### **Assessment of likely educational benefits on any existing pupils and any children and young people who would (in the future but for implementation) be likely to become pupils of the school**

Opportunities to engage with a relevant peer group in Carrongrange will be increased for existing pupils and the increased range of facilities and space will allow for wider opportunities to be provided. The development of transition classrooms and break out spaces will allow for the delivery of a bespoke curriculum whilst ensuring the right support can be provided for all children and young people when required.

By developing an all-through provision for children and young people aged 5-18, transitions will be minimised and staff will develop and maintain strong relationships with all pupils throughout their school career. This will ensure strong progressions in their learning and progress, a curriculum that builds on prior experiences and a robust approach to planning to ensure the wider holistic needs of all children and young people are met. Engagement of parents and families will continue to be a strong focus and through the development of positive and long-standing relationships, an aim will be to ensure the community is a welcoming environment where participation is encouraged and embedded.

Providing access and space for increased partnership working, including with a range of other professionals, will allow a strong focus on the holistic needs of all children and young people, including the most vulnerable learners at risk of missing out on education. The purpose-built facilities will support this approach and allow for strong multi agency working to be embedded and part of everyday practice.

### **Assessment of likely educational benefits on the pupils of any other schools in the Council area**

On completion of the work at Carrongrange, all pupils from Thistle Wing, Thistle Wing Annexe and Timezone at Maddiston Primary School will transfer to the new provision. This will allow them to attend Carrongrange for their whole educational experience, minimising transitions, strengthening positive relationships with staff and peers and building on learning experiences in order to ensure improved outcomes prior to leaving school.





A single, dedicated school leadership team and experienced staff will work with all partners and other agencies involved with the families, ensuring resources and interventions are targeted and personalised to meet their wider needs. It will ensure identified resources being provided for children and young people with profound, severe and complex needs are targeted and focused across the school and are delivered in the most efficient and effective way.

By removing the transition currently required between primary and secondary school for children attending the Thistle Wing and Timezone provisions, this will strengthen the focus on wellbeing of the children, minimise anxieties and remove the need to build positive relationships with new and unfamiliar staff.

Through increased capacity at the school, an increased number of children and young people will have access to this specialist provision which may support increased capacity across other schools.

Carronrange High School, and the new 5-18 campus, currently is and will be a service wide resource. Applications are made to secure a space for children with the most complex needs and these are allocated where appropriate. This ensures that for a child or young person, from any school, they have access to a specialist provision in order to ensure their needs are being met across learning and wellbeing.

### **Consideration of how to minimise or avoid any adverse effects that may arise from the implementation of this proposal**

Supporting children, young people and families who will transfer to Carronrange on completion of the work will be essential to minimise disruption and reduce anxieties for all. Careful planning will be required between receiving provisions and Carronrange to ensure this happens, including professional meetings, visits to current provision by Carronrange staff, visits to Carronrange campus and planned opportunities for familiarisation with the new provision. Opportunities to ensure transition plans are supported and delivered by familiar staff will be essential and careful consideration will be given to this.

Communication to all families involved, current provisions and Carronrange School will be essential to ensure children and young people can be prepared for changes and anticipate what that will mean for them. Communication approaches should be relevant to the needs of all children and young people to ensure these are accessible and relevant. This can be supported by the staff across provisions or the ASN Service.





## **Benefits for staff**

The establishment of an all through 5–18 ASN campus will create enhanced opportunities for staff to work collaboratively within a larger, more cohesive professional community. Bringing together colleagues from multiple existing ASN provisions will support deeper professional learning, shared pedagogical development and greater alignment in approaches to meeting the needs of children and young people with severe, complex and profound needs. The scale and structure of the campus will allow staff to benefit from increased access to specialist expertise, multidisciplinary partners and shared resources, helping to build collective capacity and strengthen professional confidence.

The purpose-built environment will also support staff in delivering high quality learning and teaching. Improved access to specialist facilities, such as sensory and therapy spaces, outdoor learning areas, and enhanced digital infrastructure, will make it easier for staff to plan and deliver a bespoke curriculum that reflects learners' needs. The continuity offered by a 5–18 setting will reduce the need for repeated transition planning and allow staff to develop sustained relationships with children, young people and families. This stability will support more effective professional practice, promote wellbeing for staff and enable a more consistent, team-based approach to supporting learners across the full age range.

### **Summary of educational benefits statement:**

In summary, the development of a purpose built 5-18 ASN campus at Carronrange will deliver substantial educational benefits for children and young people with profound, severe and complex needs.

The new environment will provide high quality, modern and fully accessible facilities that enable highly differentiated and bespoke learning and teaching across a wide range of contexts, including purpose designed learning spaces, sensory areas and enhanced outdoor environments.

The consolidation of existing ASN provisions into a single campus will significantly enhance the consistency and quality of learning and teaching. Staff will benefit from improved opportunities for collaboration, professional learning and the sharing of effective practice across the primary and secondary sectors.

The accessible design of the campus will allow health, therapeutic, emotional and physical needs will be met more seamlessly throughout the day, reducing barriers to learning and promoting improved outcomes. Strong existing links with partners already exist and it means the team will be able to provide seamless planning and support.





Learners will benefit from equitable access to specialist resources and facilities which are currently available only in some settings, including therapy spaces, the swimming pool and hydrotherapy pool, sensory areas and purpose designed indoor and outdoor learning environments. The increased capacity, flexibility and range of spaces will broaden opportunities for personalised learning, social development and participation in extracurricular activities.

The all through 5-18 structure will minimise transitions, support continuity in relationships and ensure a coherent and progressive learning journey for children and young people's whole school career.

The design of the new campus will facilitate strong multi agency working, enabling health, social work and family support services to operate within a familiar and accessible environment, ensuring holistic support for children, young people and their families.

Collectively, these improvements will create a modern, inclusive and nurturing learning environment that strengthens wellbeing, promotes engagement and independence, and enables all children and young people to achieve the best possible outcomes.

Greater opportunities for parental engagement and opportunities to access a range of learning environments, both internally and externally will ensure a curriculum that is inclusive, relevant and well matched to the needs of all.

#### **4. Responding to the Proposal**

This Proposal Paper has been issued following a decision on 23<sup>rd</sup> April 2026 at a meeting of the Falkirk Council Executive Committee. This Executive report is available here:

<https://coins.falkirk.gov.uk/submissiondocuments.asp?submissionid=23860>

A copy of this Proposal Paper is available on the Falkirk Council website:

[www.falkirk.gov.uk/carrongrange-campus-consultation](http://www.falkirk.gov.uk/carrongrange-campus-consultation)

This proposal document will be provided by email or letter to:

- Parents and carers of all pupils at each school directly affected by the proposal (Kinnaird Primary School, Maddiston Primary School, Moray Primary School and Carrongrange High School).
- Parents of all pre-school and primary age children who could attend any of the affected schools within the next 2 years.
- Parent Councils at all affected schools.
- Pupils at all affected schools.
- Staff and trade unions at all affected schools.





- Community groups/organisations across the Falkirk Council area (including Community Councils and relevant Community Planning partners).
- MPs, MSPs and Elected Members of Falkirk Council.
- Professional Partners (NHS, Social Work etc)

A copy of this document is also available from:

- Education Services, Suite 1A, Falkirk Community Stadium, 4 Stadium Way, Falkirk, FK2 9EE

This document can be made available in alternative formats or in translated form for readers whose first language is not English. Please apply to Education Services, Suite 1A, Falkirk Community Stadium, 4 Stadium Way, Falkirk, FK2 9EE by telephone on 01324 506600 or by email

[educ.consultation@falkirk.gov.uk](mailto:educ.consultation@falkirk.gov.uk)

### **Length of the Consultation**

The consultation will take place between 27 April 2026 and 12 June 2026.

### **Public Meeting**

There will be a public meeting held at Carronrange High School, Oxgang Road, Grangemouth, FK3 9HP on 19<sup>th</sup> May at 18.30.

Two online meetings will be held:

20<sup>th</sup> May 2026 18:30 – 19:30. Teams Meeting Link:

<https://teams.microsoft.com/meet/350388969948257?p=TafdH3Aj9ZaRgoAgsi>

Meeting ID: 350 388 969 948 257

Passcode: Uu7cw2ov

25<sup>th</sup> May 2026 12:30-13:30. Teams Meeting Link:

<https://teams.microsoft.com/meet/37377644533288?p=GgNVKgZrF3be8V4Pq7>

Meeting ID: 373 776 445 332 88

Passcode: Y6bK7dr7

These meetings will be an opportunity for interested parties to:

- Hear about the proposal.
- Ask questions about the proposal.
- Have their views recorded so that they can be taken into account as part of the consultation process.





A note will be taken at the meeting of questions and views. This note will be published in the consultation report which will be available on the Council website.

### **How to Respond to the Proposal**

Interested parties are invited to respond on the proposal:

- Online: <https://participateplus.falkirk.gov.uk>
- By email: [educ.consultation@falkirk.gov.uk](mailto:educ.consultation@falkirk.gov.uk)
- In writing: New 5-18 ASN Campus Consultation, Education Services, Suite 1A, Falkirk Community Stadium, 4 Stadium Way, Falkirk, FK2 9EE

**All responses should be provided by 12<sup>th</sup> June 2026.**

### **Consultation with Children and Young People**

Pupils at affected schools will be consulted in an age and ability appropriate manner about the proposal in school and further information about this will be provided to parent/ carers.

Councils usually work through schools to gather pupil views, such as early engagement including:

- Class discussions or facilitated workshops
- Pupil council meetings or focus groups
- Structured activities led by teachers or senior staff

These child friendly approaches help ensure children understand:

- What is being proposed
- Why it is being considered
- How it might affect them personally

This is encouraged in statutory guidance as good practice.

### **Following the Consultation**

His Majesty's Inspectorate of Education for Scotland (HMIE) – When the proposal document is published, a copy will also be sent to HMIE by the Education Authority. HMIE will also receive a copy of any relevant written representations received by the Authority from any person during the consultation period or, if HMIE agree, a summary of them. HMIE will further receive a summary of any oral representations made to the Local Authority at the public meeting which will be held and, as available (and so far, as otherwise practicable), a copy of any other relevant documentation.





HMIE will then prepare a report on the educational aspects of the proposal not later than 3 weeks after the Authority has sent them all representations and documents mentioned above. The 3-week period will not start until after the consultation period has ended. In preparing their report, HMIE may enter the affected school and make such reasonable enquiries of such people they consider appropriate and may make such reasonable enquiries as they consider appropriate.

Falkirk Council – the Education Authority will review the proposal having regard to the HMIE Report, written representations that it has received, and oral representations made to it by any person at the public meeting. It will then prepare a consultation report. This report will be published in electronic and printed formats. It will be available from the Council website and from Education Services, Suite 1A, Falkirk Community Stadium, 4 Stadium Way, Falkirk, FK2 9EE free of charge. Anyone who made written representations to the Authority during the consultation period will also be informed about the report.

The report will include:

- A record of the total number of written representations made to the Authority during the consultation period.
- A summary of the written representations.
- A summary of the oral representations made at the public meeting.
- The Authority's response to the HMIE Report as well as any written or oral representations it has received, together with a copy of the HMIE Report and any other relevant information, including detail of any alleged inaccuracies and how these have been handled.
- A statement explaining how the Authority complied with the requirement to review the proposal in light of the HMIE Report and representations (both written and oral) that it received.

The consultation report will be published and available for further consideration for a period of at least 3 weeks.

This report together with any other relevant documentation, will be considered by the Executive of Falkirk Council, who will come to a decision about the proposal.

### **Note of Corrections**

If any inaccuracy or omission is discovered in this proposal document, either by the Council or any person, the Council must investigate and decide what, if any, action is required.

If relevant information has been omitted or there has been an inaccuracy, the Council will then take appropriate action, which may include the issue of a correction notice, the publishing of a corrected Proposal Paper or the revision of the timescale for the consultation period, if appropriate. In that





event, relevant consultees and HMIE will be advised. The Authority must inform the person who made the allegation and what action it has taken.

### **Notification to Scottish Ministers**

If the education authority makes a final decision to implement the closure proposal, it will require to notify the Scottish Ministers of that decision and provide them with a copy of the proposal document and the consultation report. This must be done within 6 working days of that decision.

The education authority must also publish on its website the fact that it has notified Scottish Ministers of its decision and of the period during which consultees can make representation to Ministers. The Scottish Ministers have an 8-week period from the date of that final decision to decide if they will call-in the proposal. Within the first 3 weeks of that 8-week period, the Scottish Ministers will take account of any relevant representations made to them by any person. Until the outcome of the 8-week call-in process is known, the authority cannot proceed to implement the proposal.

If Scottish Ministers decide to call in a closure proposal, they must refer it to the Convener of the School Closure Review Panels for determination by a School Closure Review Panel. The authority may not implement the proposal (wholly or partly) unless the Panel has granted consent to it (with or without conditions) and either the period for making an appeal to the Sheriff has expired or, if an appeal has been made, it has either been abandoned or the Sheriff has confirmed the Panel's decision.

The School Closure Review Panel may refuse to consent to the proposal, refuse consent and remit the proposal back to the authority or grant their consent to the proposal subject to conditions or unconditionally.

- Ministers have a power to call in a closure decision, but only where it appears to Ministers that the Council has failed in a significant regard to comply with the Schools (Consultation) (Scotland) Act's requirements or, in coming to its decision, has failed to take proper account of a material consideration relevant to the proposal. Ministers have up to 8 weeks from the date of the Council's decision to decide whether or not to issue a call-in notice.
- During the first 3 weeks of this period, anyone is able to make representations to Ministers on whether the decision should be called in.
- During the call-in period, the Council may not proceed further, in whole or part, with the proposed closure. Ministers may come to a decision sooner than 8 weeks (but not before the 3 weeks for representations to be made to them has elapsed).
- The Schools (Consultation) (Scotland) Act, as amended, gives Ministers and School Closure Review Panels the right to call on advice from HMIE in relation to a proposal at the call-in or determination stage.





This consultation is being conducted having regard to the terms of the Schools (Consultation) (Scotland) Act 2010.

23<sup>rd</sup> April 2026

Jon Reid  
Director of Education Services





## Appendix 1 – Financial Assessment

This proposal represents a £30 million Capital investment in the Learning Estate agreed at the meeting of [Falkirk Council on 26 March 2026](#).

This is not a savings proposal. The closure of the ASN wings associated Kinnaird and Maddiston Primary Schools will be replaced with improved provision at the new-build 5-18 campus in Grangemouth.

Table 1 overleaf details the current costs for ASN primary wing provision across the 3 sites.

It is anticipated that current staff and existing budgets will transfer in full. Staffing and operational budgets will be reviewed over time to align with increasing pupil numbers as the additional capacity provided by the new facility is utilised.

Home to school transport costs are expected to remain at similar levels, though may increase as pupil numbers rise.

The existing buildings used by the Thistle Wing, Thistle Wing Annexe and Timezone, once vacated, will be retained as part of the learning estate (at Kinnaird Primary School, Larbert High School Campus and Maddiston Primary School respectively). We do not expect a significant change in property running costs as a result.

Table 2 overleaf details the current costs for Carrongrange High School and the employee, operational and transport costs that would transfer to the new 5-18 ASN campus following relocation of Primary pupils and closure of the 3 ASN wings.

The running costs for the new facility cannot be accurately estimated at this stage, but there will be added property costs with the new facility, together with increased staffing over time as the additional capacity provides school provision for an increasing number of ASN pupils. It is important to note that the building will be constructed according to Passivhaus principles, which will ensure low energy consumption, and together with LED lighting throughout, this will contribute to very low whole-life costs when compared to other schools of a similar size.



Table 1: Current costs for ASN Wings (Financial Year 2025/26)

Table 1: Current costs for ASN Wings (Financial Year 2025/26)

	Kinnaird - Thistle Wing	Kinnaird - Thistle Wing Annexe	Total for Kinnaird - Thistle Wing and Thistle Wing Annexe	Maddiston - Timezone	Combined Total
<b>Employee Costs</b>			<b>£1,820,300</b>	<b>£941,390</b>	<b>£2,761,690</b>
Teaching staff			£1,019,310	£605,430	£1,624,740
Support staff			£790,320	£329,510	£1,119,830
Staff training			£1,680	£960	£2,640
Supply costs			£8,990	£5,490	£14,480

<b>Property costs</b>	<b>£129,090</b>	<b>£608,540</b>	<b>£737,630</b>	<b>£123,230</b>	<b>£860,860</b>
Property insurance	£2,730	£15,070	£17,800	£2,380	£20,180
Non-domestic rates	£29,720	£36,300	£66,020	£22,090	£88,110
Water and sewerage	£2,490	£9,590	£12,080	£2,560	£14,640
Energy costs	£11,970	£123,970	£135,940	£11,370	£147,310
Cleaning	£20,900	£28,000	£48,900	£11,030	£59,930
Repair & maintenance	£1,440	£10,000	£11,440	£1,710	£13,150
Grounds maintenance	£140	£3,900	£4,040	£170	£4,210
Facilities management	£4,490	£12,500	£16,990	£4,110	£21,100
Capital charges	£55,210	£369,210	£424,420	£67,810	£492,230

<b>Operational costs</b>			<b>£23,410</b>	<b>£6,320</b>	<b>£29,730</b>
Learning materials			£1,750	£580	£2,330
Catering			£21,220	£5,650	£26,870
Other (e.g. licences)			£440	£90	£530

<b>Transport Costs</b>	<b>£105,990</b>	<b>£251,230</b>	<b>£357,220</b>	<b>£148,860</b>	<b>£506,580</b>
Home to school	£105,990	£251,230	£357,220	£148,600	£505,820
Other pupil transport			£450	£190	£640
Staff travel			£50	£70	£120



<b>GROSS EXPENDITURE</b>			<b>£2,939,060</b>	<b>£1,219,800</b>	<b>£4,158,860</b>
--------------------------	--	--	-------------------	-------------------	-------------------

<b><i>Income</i></b>	<b>£0</b>	<b>£0</b>	<b>£0</b>	<b>£0</b>	<b>£0</b>
Sale of meals	£0	£0	£0	£0	£0
Lets	£0	£0	£0	£0	£0
External care provider	£0	£0	£0	£0	£0
Other	£0	£0	£0	£0	£0
<b>NET EXPENDITURE</b>			<b>£2,939,060</b>	<b>£1,219,800</b>	<b>£4,158,860</b>



**Table 2: Current costs for Carronrange High School and budgets to be transferred from ASN wings to new 5-18 ASN Campus (Financial Year 2025/26)**

	Current Costs (Carronrange High School)	Budgets transferring from ASN Wings to Carronrange 5-18 Campus	Additional Costs associated with New Build Elements of 5-18 Carronrange Campus
<b>Employee Costs</b>	<b>£6,210,100</b>	<b>£2,761,690</b>	
Teaching staff	£3,471,290	£1,624,740	
Support staff	£2,669,300	£1,119,830	
Staff training	£7,090	£2,640	
Supply costs	£62,420	£14,480	
<b>Property costs</b>	<b>£1,050,710</b>	<b><i>The property costs of the existing ASN wings will remain attached to the current buildings.</i></b>	<b><i>There will be added property costs with the new facility, but these are not known at this stage.</i></b>
Property insurance	£27,370		
Non-domestic rates	£0		
Water and sewerage	£230		



Energy costs	£230,630		
Cleaning	£110,730		
Repair & maintenance	£38,610		
Grounds maintenance	£0		
Facilities management	£59,090		
Capital charges	£584,050		
<b>Operational costs</b>	<b>£119,050</b>	<b>£29,730</b>	
Learning materials	£20,300	£2,330	
Catering	£85,500	£26,870	
SQA Costs	£5,320	£0	
Other (e.g. licences)	£7,930	£530	
<b>Transport Costs</b>	<b>£651,430</b>	<b>£506,580</b>	
Home to school	£636,260	£505,820	





Other pupil transport	£14,780	£640	
Staff travel	£390	£120	
<b>GROSS EXPENDITURE</b>	<b>£8,031,290</b>	<b>£3,298,000</b>	
<b>Income</b>	<b>-£324,170</b>	<b>£0</b>	
Sale of meals	-£1,350	£0	
Lets	£0	£0	
External care provider	£0	£0	
Other	-£322,820	£0	
<b>NET EXPENDITURE</b>	<b>£7,707,120</b>	<b>£3,298,000</b>	





# Appendix 2 – Proposed ASN 5-18 Campus

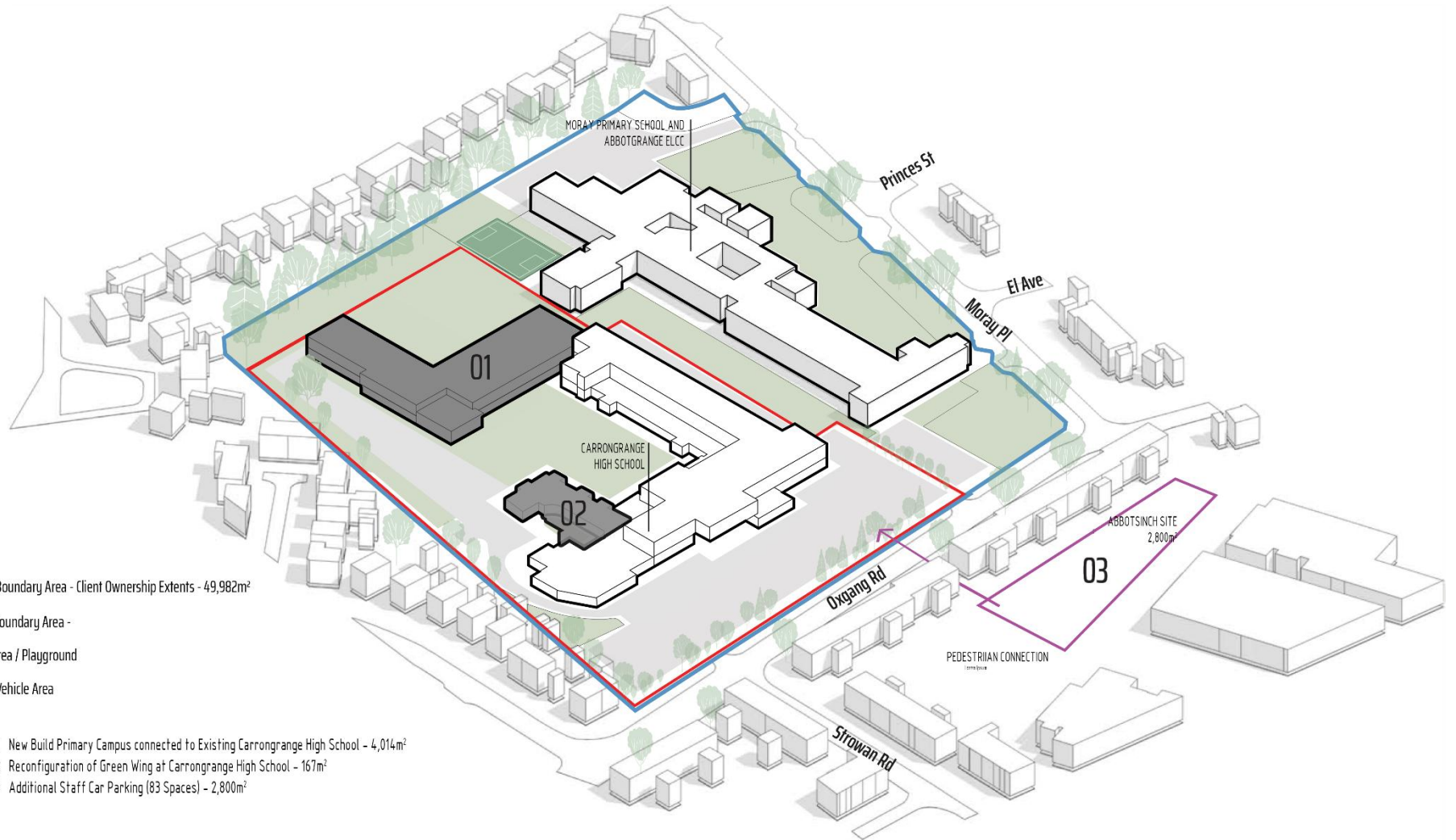

### KEY

-  Blue Line Boundary Area - Client Ownership Extends - 49,982m<sup>2</sup>
-  Red Line Boundary Area -
-  Outdoor Area / Playground
-  Parking / Vehicle Area
-  Proposed
  - 01 New Build Primary Campus connected to Existing Carronrange High School - 4,014m<sup>2</sup>
  - 02 Reconfiguration of Green Wing at Carronrange High School - 167m<sup>2</sup>
  - 03 Additional Staff Car Parking (83 Spaces) - 2,800m<sup>2</sup>

